

Course & Distance
up Chartiers Creek.

S.	46	W.	16 post
S.	5	E.	8.8 P.
N.	66	W.	5. P.
S.	50	W.	13. P.
S.	41	E.	5.2 P.
S.	32	W.	31. P.
S.	4	W.	28. W. Walnut.
S.	5	E.	18. P.
S.	58	W.	12. P.
S.	19	W.	6. P.
S.	63	W.	4. P.
S.	7	E.	7. P.
N.	84	E.	8. P.
S.	12	E.	8. P.
S.	58	W.	8. P.
S.	24	W.	8. P.
S.	16	E.	7. P.
S.	46	W.	9. P.
S.	18	W.	12. P.
S.	27	E.	8. P.
S.	78	E.	3. P.
S.	8	W.	5. Post.
			230 perches up Creek.

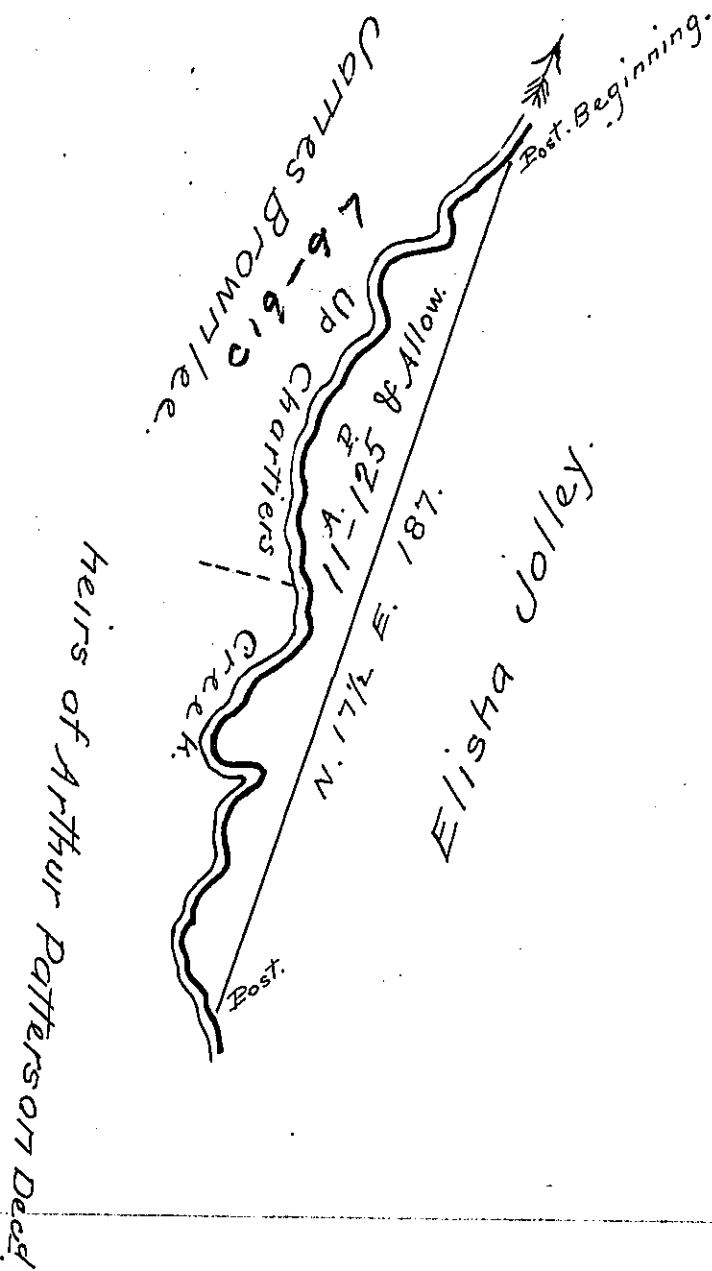

The above is a Draught of a Survey made June 11th 1835 in pursuance of a warrant granted to John Jolley for 20 Acres Dated June 4th 1835 Containing Eleven Acres and 125 perches and Allowance of six per Cent. situate in Canton - Township Washington County on the Waters of Chartiers Creek.

Stephen Woods D.S.

Jacob Spangler Esq. }
Surveyor General. }

IN TESTIMONY that the above is a copy of the original remaining on file in the Department of Internal Affairs of Pennsylvania, made conformably to an Act of Assembly approved the 16th day of February, 1833, I have hereunto set my Hand and caused the Seal of said Department to be affixed at Harrisburg, this fifth day of June 1905.

Loose B. Brown
Secretary of Internal Affairs.